



# ASPIRE RESIDENTIAL

Service | Expertise | Accountability



## Detached House – Period Property with Huge Potential – Worthing Town Centre Offers In The Region Of £870,000

A rare opportunity to acquire this detached period home in a sought-after area of Worthing. In need of modernisation throughout, this impressive property offers generous living space, original features, and enormous scope to create a stunning family home.

Situated in a quiet close, this charming home is perfect for those looking to put their own stamp on a property. With excellent transport links, local amenities, and the seafront nearby, this is a forever home in the making.



Council Tax Band:



- Detached period property
- High ceilings & original features
- Off-street parking & garage
- Currently 2 x 2 bedroom flats with a planning application submitted for a single dwelling
- EPC - D
- Minimum four spacious bedrooms
- Generous South facing garden
- Fantastic opportunity for someone to create a large family home
- Popular Worthing location close to the seafront, town centre and train station
- Situated in a quiet close





Worthing, a picturesque seaside town on the south coast of England, exudes a unique charm with its blend of Victorian elegance and contemporary vitality. Known for its extensive pebble beach, historic pier, and well-maintained promenade, Worthing offers residents and visitors alike a captivating coastal experience. The town's vibrant cultural scene is enriched by theatres, art galleries, and frequent events, creating a lively atmosphere. With its beautiful parks, such as Beach House Park and Highdown Gardens, Worthing provides green spaces for leisure and relaxation. The town's bustling town centre features a diverse array of shops, restaurants, and entertainment venues, contributing to its reputation as a welcoming and thriving community. Worthing's accessibility, rich history, and scenic beauty make it a sought-after destination for those seeking a coastal haven with a perfect blend of tradition and modernity.

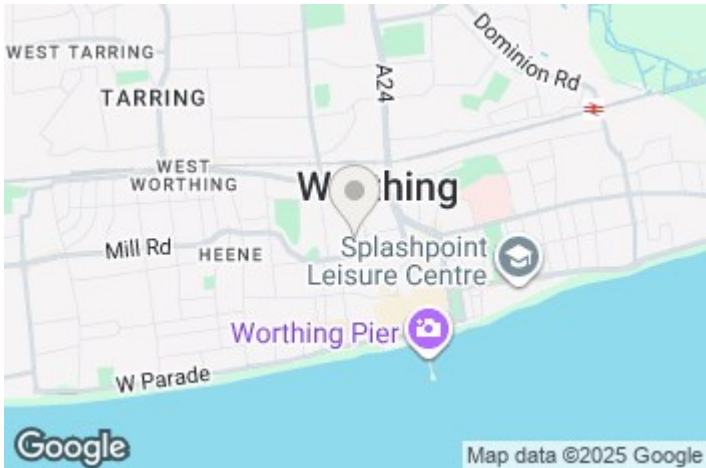

EPC Rating:  
D

Energy Efficiency Rating		
	Current	Potential
Very energy efficient - lower running costs		
(92 plus) A		
(81-91) B		
(69-80) C		
(55-68) D	66	80
(39-54) E		
(21-38) F		
(1-20) G		
Not energy efficient - higher running costs		
England & Wales		
EU Directive 2002/91/EC		

## Abbotts Close, Worthing, BN11

Approximate Area = 2476 sq ft / 230 sq m  
 Limited Use Area(s) = 90 sq ft / 8.4 sq m  
 Garage = 203 sq ft / 18.8 sq m  
 Outbuilding = 171 sq ft / 15.9 sq m  
 Total = 2940 sq ft / 273.1 sq m  
 For identification only - Not to scale

Denotes restricted  
head height

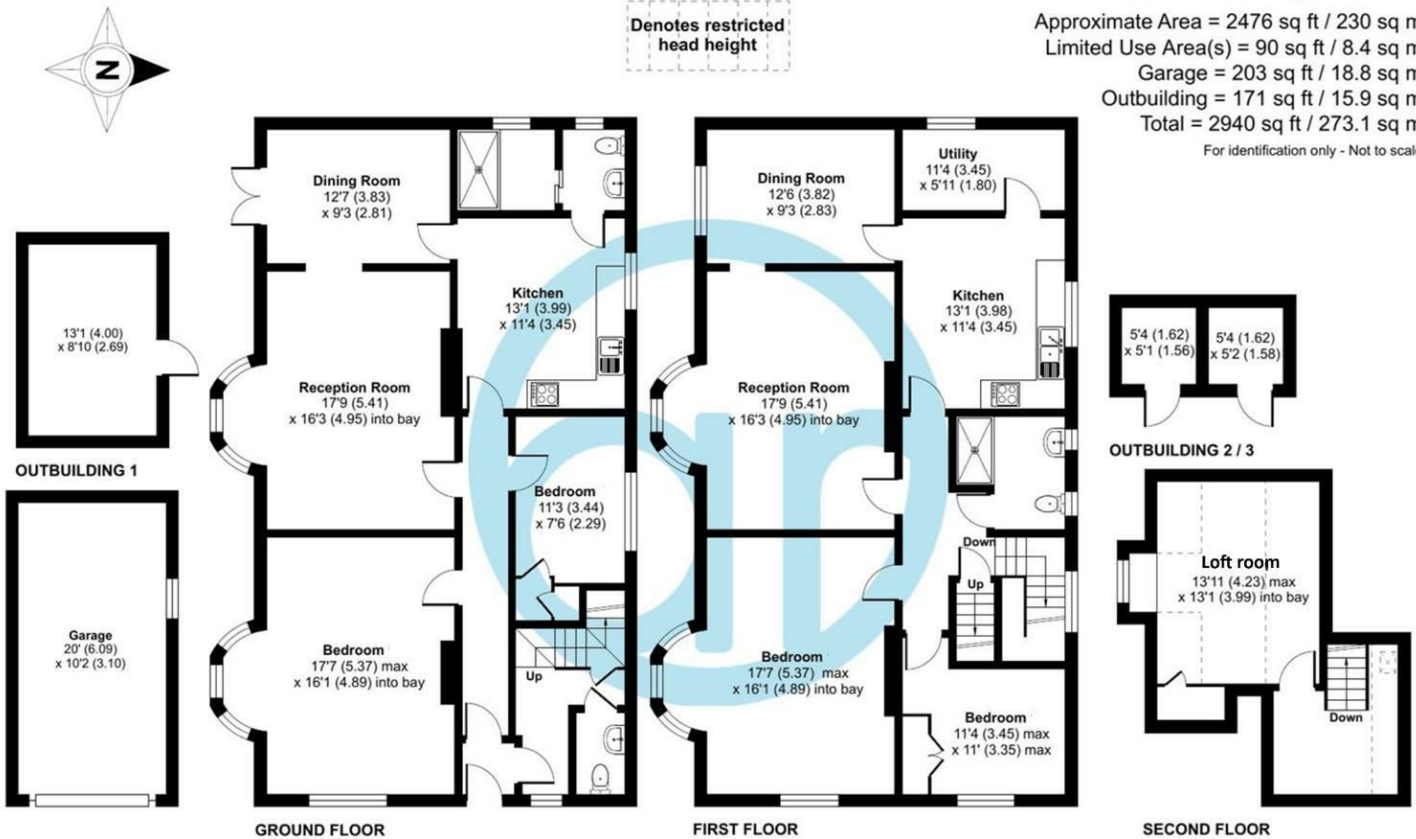

Floor plan produced in accordance with RICS Property Measurement 2nd Edition, incorporating International Property Measurement Standards (IPMS2 Residential). © nitchecom 2025. Produced for Aspire Residential Real Estate. REF: 1328654

### Aspire Residential | Goring-by-Sea

28 Goring Road  
 Goring-by-Sea  
 Worthing  
 BN12 4AD  
 Telephone: 01903 259 961  
 Email: [info@aspireresidential.co.uk](mailto:info@aspireresidential.co.uk)



### Aspire Residential | Durrington / Salvington

5 Selden Parade  
 Salvington Road  
 Worthing  
 BN13 2HL  
 Telephone: 01903 910 424  
 Email: [enquiries@aspireresidential.co.uk](mailto:enquiries@aspireresidential.co.uk)

Aspire Residential and Aspire Residential Estate Agents are trading names of Aspire Residential Sales Limited, a Company registered in England and Wales with registration number 11659289. VAT No. 317450614

**IMPORTANT NOTICE TO PURCHASERS:** We endeavour to make our sales particulars accurate and reliable, however, they do not constitute or form part of an offer or any contract and none is to be relied upon as statements of representation or fact. The services, systems and appliances listed in this specification have not been tested by us and no guarantees as to their operating ability or efficiency are given. All measurements have been taken as a guide to prospective buyers only, and are not precise. If you require clarification or further information on any points, please contact us, especially if you are traveling some distance to view.